

# A15P

## Volkswagen Amarok Dual Cab



A15P	LID		
PART DISCRIPTION	PART NUMBER	QUANTITY/LENGTH	CHECK
LID FRONT HINGES	1135	2	
LID TUB MOUNTS WITH PINS	1177	2	
GAS STRUTS	S700-220	2	
STRUT BODY MOUNTS	1040	2	
M8 U BOLT	UB	2	
LOCK STRICKER BRACKETS	1189B	2	
<b>LID NUTS AND BOLTS</b>			
M8 BOLTS	25	8	
M8 WASHER (3MM THICK)	24	8	
SELF DRILL SCREWS	19	18	
M8 NUTS	23	8	
<b>SPORTS BAR NUTS AND BOLTS</b>			
M6 WASHER	11	4	
M6 SPRING WASHER	13	4	
M6 40MM BOLTS	18	4	
<b>OTHER</b>			
Allen Key	42	1	
SPORTS BAR FEET CUPS	CPS-1	SET	
ALCOHOL WIPE		1	
FITTING INSTRUCTION MANUAL		1	

# Fitting Instructions Part Number A15 Volkswagen Amarok Dual Cab 2011+ To suit Sports Bars

*Check contents of kit before commencing fitment and report any discrepancies*

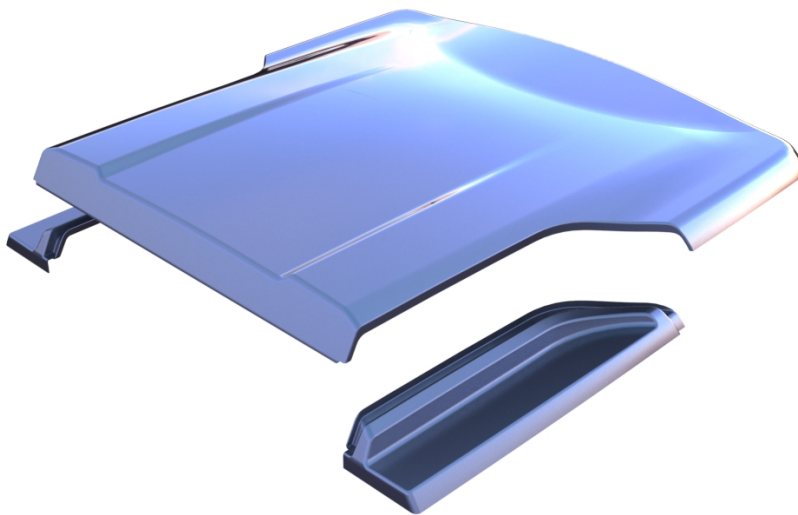

\*Image example shown only

<b>IMPORTANT</b>	<ul style="list-style-type: none"> <li>• Do not stand/sit or rest heavy objects on Tonneau Cover</li> <li>• Humans or animals are not to be under the closed Tonneau at any given time</li> <li>• Securely lock tonneau Cover before operating vehicle</li> <li>• Tonneau Cover is not dust or water tight</li> <li>• Do not carry open volatile chemicals with Tonneau Cover installed</li> <li>• If contact with volatile chemicals occur, clean Tonneau with mild detergent and water solution</li> </ul>			
<b>Care Instructions</b>	<ul style="list-style-type: none"> <li>• Read Instructions fully before commencing installation.</li> <li>• Clean Tonneau Cover with a mild detergent and water solution</li> <li>• Do not use abrasive cleaners or solvents</li> <li>• Refer to manufactures instructions applicable to power drill.</li> <li>• Protect Tub floor against scratches during installation process.</li> </ul>			
<b>Maintenance</b>	<p>If lubrication of the locks or hinges is required use only Graphite Powder. DO NOT use any other lubricants or oils.</p>			
<b>Tools Required</b>	<table style="width: 100%; border: none;"> <tr> <td style="vertical-align: top;"> <ul style="list-style-type: none"> <li>• Pen / Marker</li> <li>• Centre Punch</li> <li>• Drill &amp; Drill bits</li> <li>• Phillips head screwdriver</li> <li>• Caulking Gun</li> <li>• Silicon - Non Acetic</li> </ul> </td> <td style="vertical-align: top;"> <ul style="list-style-type: none"> <li>• Die Grinder &amp; multi tool</li> <li>• Masking Tape</li> <li>• Scissors &amp; Knife</li> <li>• Ruler</li> <li>• Spanner &amp; Socket</li> <li>• Tape measure</li> </ul> </td> <td style="vertical-align: top;"> <ul style="list-style-type: none"> <li>• Soapy water solution</li> <li>• Allen Key set (Metric)</li> </ul> </td> </tr> </table>	<ul style="list-style-type: none"> <li>• Pen / Marker</li> <li>• Centre Punch</li> <li>• Drill &amp; Drill bits</li> <li>• Phillips head screwdriver</li> <li>• Caulking Gun</li> <li>• Silicon - Non Acetic</li> </ul>	<ul style="list-style-type: none"> <li>• Die Grinder &amp; multi tool</li> <li>• Masking Tape</li> <li>• Scissors &amp; Knife</li> <li>• Ruler</li> <li>• Spanner &amp; Socket</li> <li>• Tape measure</li> </ul>	<ul style="list-style-type: none"> <li>• Soapy water solution</li> <li>• Allen Key set (Metric)</li> </ul>
<ul style="list-style-type: none"> <li>• Pen / Marker</li> <li>• Centre Punch</li> <li>• Drill &amp; Drill bits</li> <li>• Phillips head screwdriver</li> <li>• Caulking Gun</li> <li>• Silicon - Non Acetic</li> </ul>	<ul style="list-style-type: none"> <li>• Die Grinder &amp; multi tool</li> <li>• Masking Tape</li> <li>• Scissors &amp; Knife</li> <li>• Ruler</li> <li>• Spanner &amp; Socket</li> <li>• Tape measure</li> </ul>	<ul style="list-style-type: none"> <li>• Soapy water solution</li> <li>• Allen Key set (Metric)</li> </ul>		

# Installation Steps Flow Chart

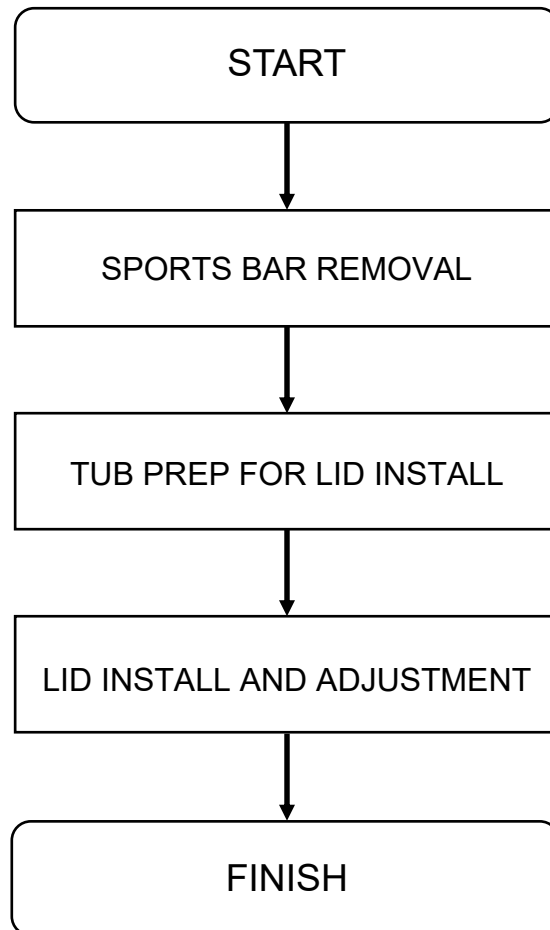

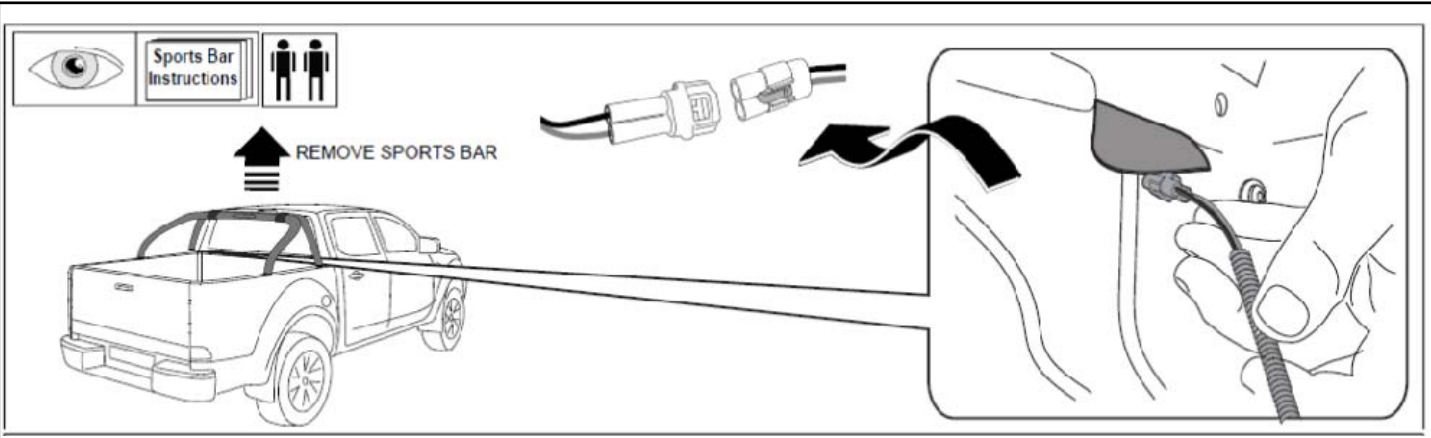

**Note: Two people are required to complete the installation.**  
 Pull the Stop Lamp wiring Loom from the hole in the front left hand corner of the vehicle tub, where the front left hand side foot is located and disconnect the Connector. Remove the Sports Bar and retain all the hardware.

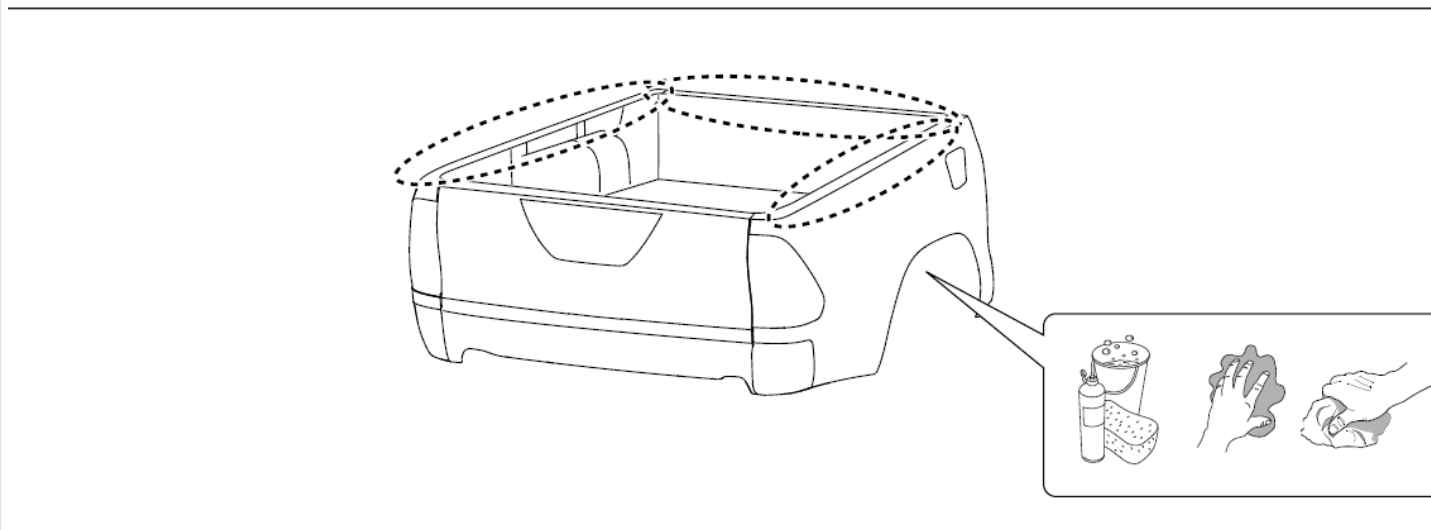

Thoroughly clean installation areas.

**Important:**  
 Instructions are for Utes with an UNDER-RAIL tubliner. If you have an OVER-RAIL tubliner you must trim the top off.

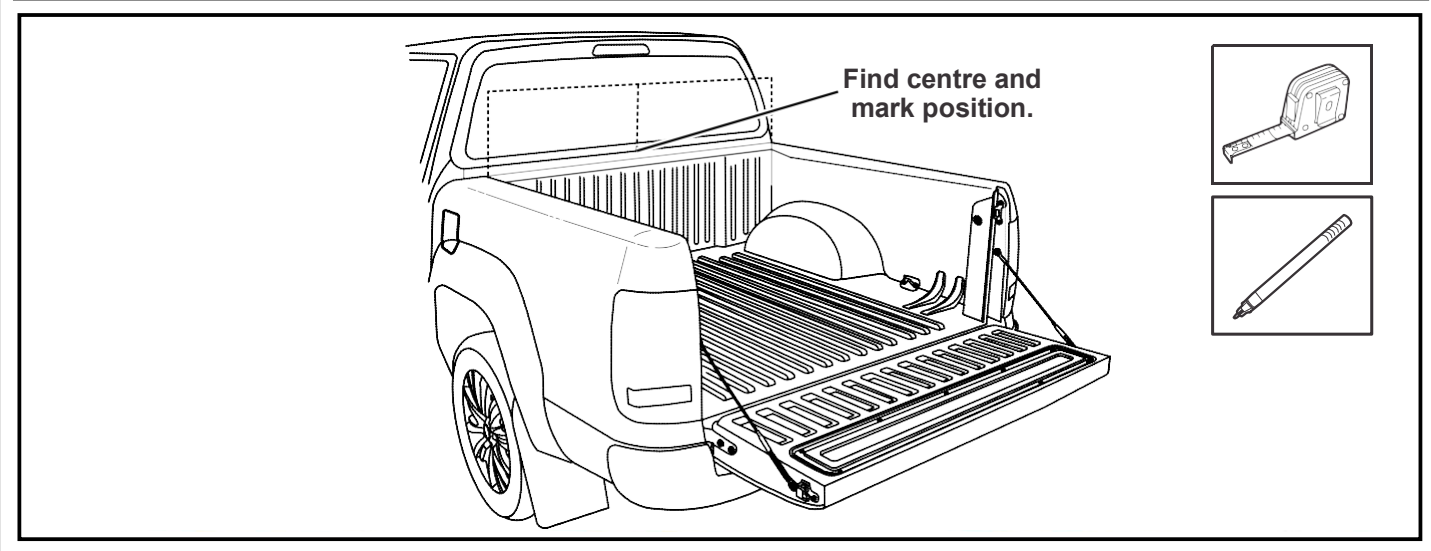

### Hinge mounts:

Align the hinge mounts along front of tray, ensuring the hinges are properly positioned from centre of tub **460 mm** to centre of hinge mount either side along the inside of the front of tub. Attach the hinges using self-drilling screws (supplied) through holes pre-drilled into the hinges. Apply clear or black silicone to any gaps and between the hinges and the vehicle to prevent water entry.

Measure distance from centre on both sides and mark.

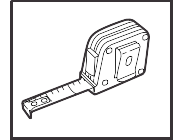
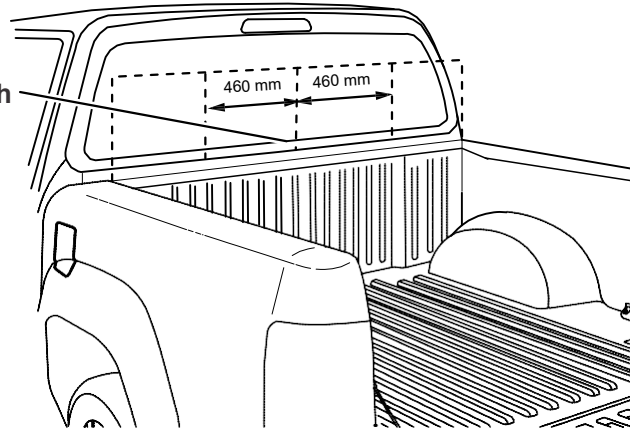

Measure and mark the positions as indicated above from the centre of the bed for placement of the bottom hinges.  
**WARNING: RECHECK DIMENSIONS TO ENSURE CORRECT MEASUREMENT**

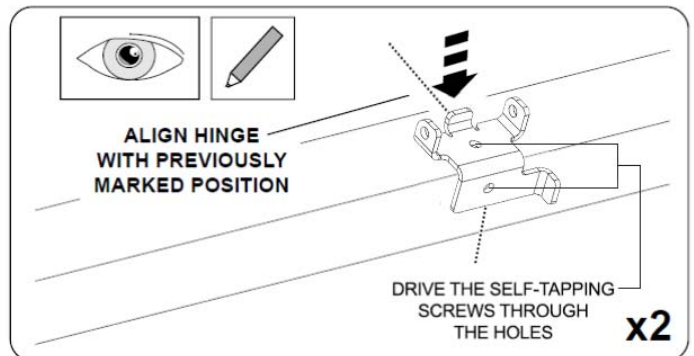
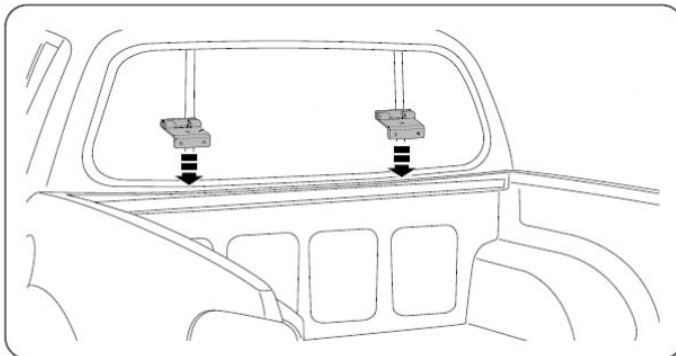

Drive the self-tapping screws through the holes in the top and the base of the hinge plate into the tub. Tighten to 3Nm.

### Gas Struts:

Measure from the front rail inside of tub, measure along top edge of tray **935 mm** (windscreen end) then down **20mm** and mark the screws position for the gas strut bracket. Position the gas strut bracket accordingly, mark two mounting holes and centre. Refer to Fig. 1 and Fig. 2

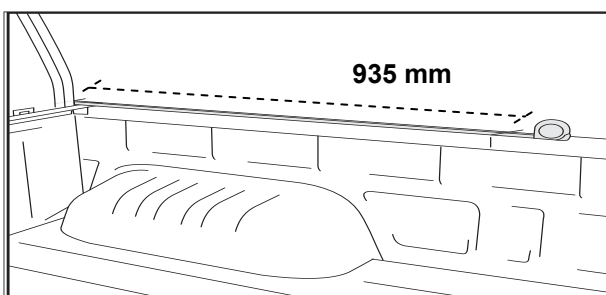

Fig.1 - Gas strut bracket location

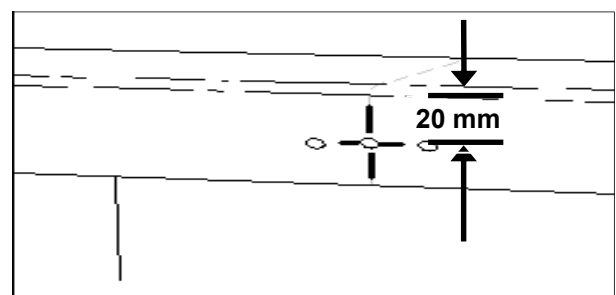
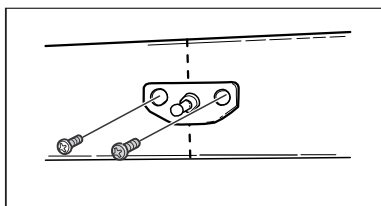

Fig.2 - Gas strut bracket location

Using a **2 mm** diameter drill bit set to **5 mm** drill stop. Drill two pilot holes. Attach small gas strut bracket using self drilling screws provided. Repeat process on other side of tray. **Refer to Fig. 2 and Fig.3**



**Fig.3 - Gas strut bracket fitment**

Attach small shaft end of gas strut onto gas strut brackets, by clicking them in place. **Refer to Fig.4 with regard to gas strut orientation.**

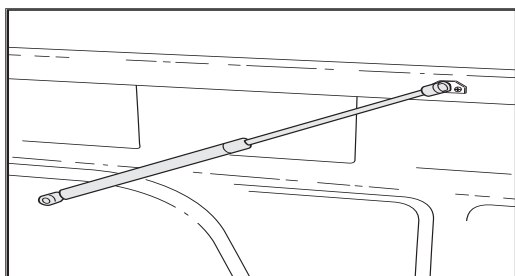
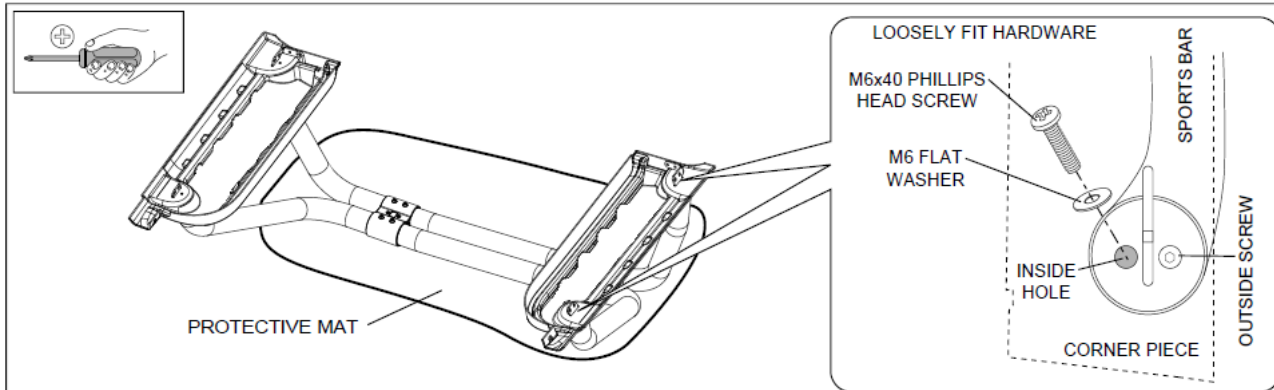
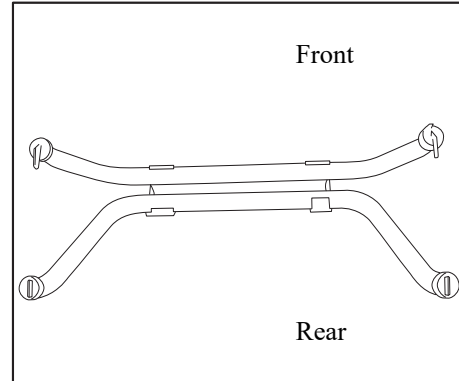

**Fig.4 - Gas strut orientation**

**Important:**  
**DO NOT over tighten screws. Recommended tightening torque is 1- 3 Nm**

Turn the Sportsbar upside down. Remove all the moulded feet cups from the Sportsbar. Carefully cut the excess of the moulded feet cups so it is flat all around, then fit the moulded feet cups back onto the Sportsbar.

Silicon needs to be applied to the underside of the moulded feet cups to minimize the chance of water leakage.



Turn the Sports Bar upside down and place Sports Bar on a protective mat to avoid scratching.  
Fit corner pieces to sports bar as shown ensuring they are on the correct side.  
Loosely fit M6x40 phillips head screw and M6 flat washer to secure the corner pieces to the sports bar as shown.

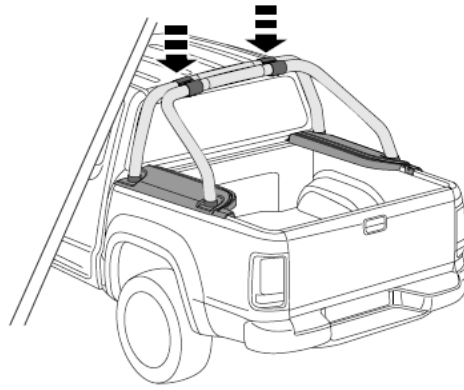

Carefully position the assembled sportsbar and corner pieces onto the tub, taking care not to scratch the vehicle.  
**NOTE: Two people are required to lift into position.**

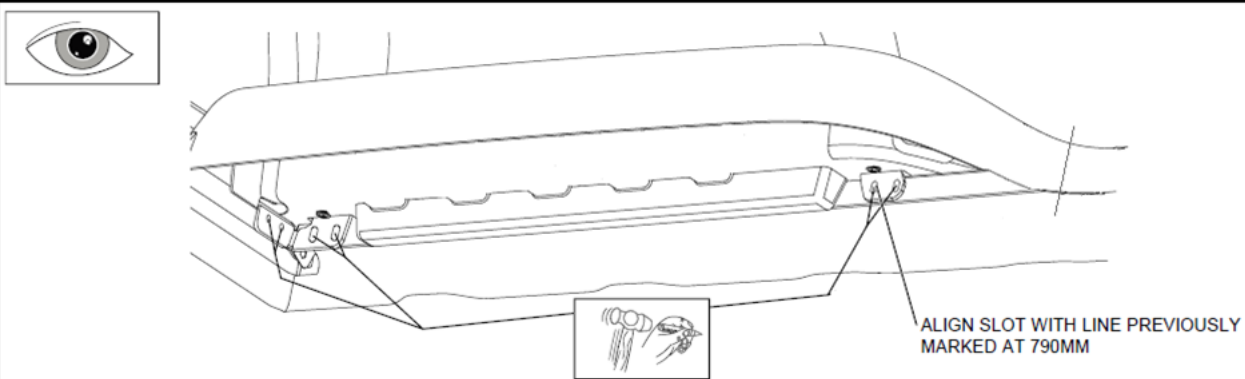

Two people are required for this step, one to apply firm pressure and the other to mark the positions.  
 Apply pressure to push the corner piece and front sports bar feet firmly into the front corner of the tub and down onto the side rail. Centre-punch mark the front four (4) hole positions. Align the front slot on the rear sports bar feet with the line marked at 790mm (from previous step), and centre-punch mark the rear two (2) hole positions.  
 Push the rear of the corner piece against the tub and mark the hole position.  
 All factory fitted sports bars are fitted differently at the time so new hole's may need to be drilled in order for the infills and sportsbars to sit correctly.

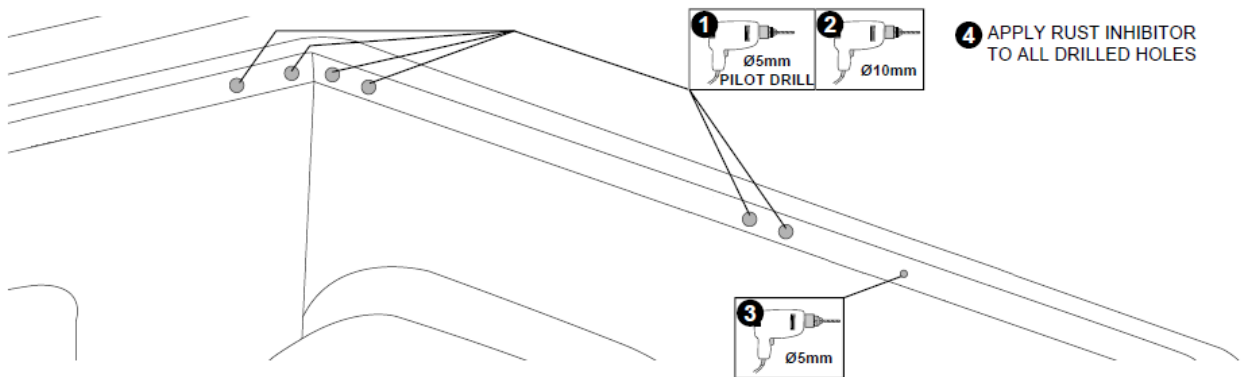

Drill the six (6) sports bar feet hole positions marked with a Ø5mm pilot drill, then re-drill to Ø10mm holes. Drill the rear corner piece hole to Ø5mm. Remove all burrs, sharp edges and swarf from vehicle. Apply rust inhibitor to all drilled holes.



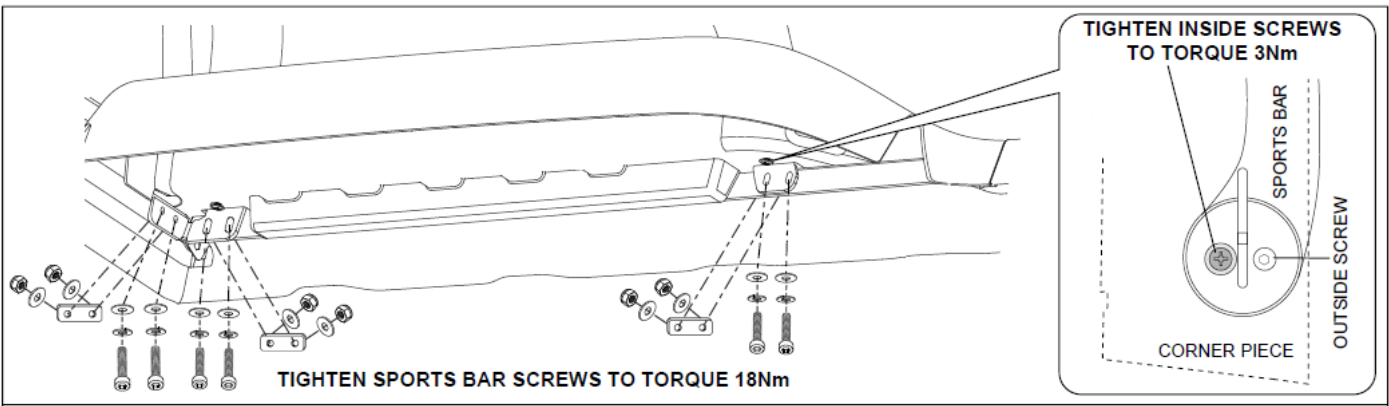

Re-fit the sports bar and corner pieces to the vehicle. Secure the sports bar to the vehicle with hardware from the sports bar kit for both sides as shown. Tighten all the inside screws to **Torque 3Nm** securing the sports bar to the corner pieces as shown. Tighten all the sports bar screws to **Torque 18Nm** as shown. Fit a rivet to secure the corner piece to the tub as shown.

**Attach lid hinges to tub hinges by aligning and pushing pin through. Click pin down into hinge locking tab**

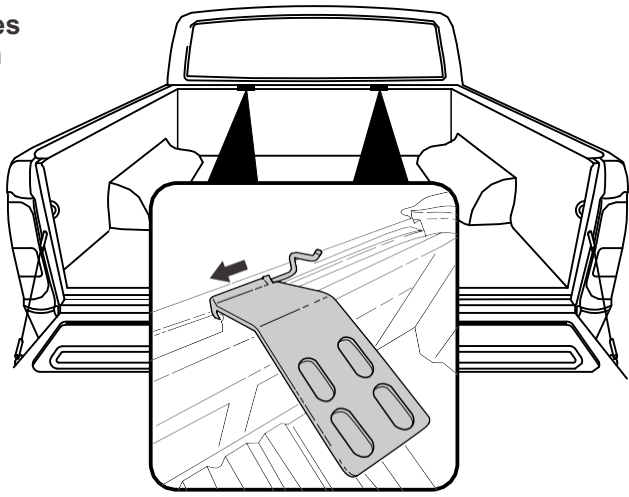

**Fit the lid and adjust so it is even on both sides and forward as far as possible while staying level.**

**Note: When gas struts are fitted, lid will be pulled back slightly.**

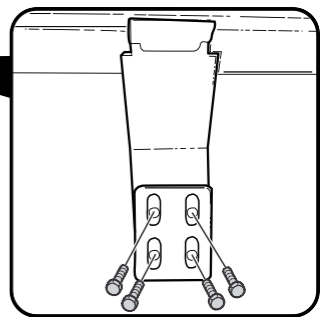
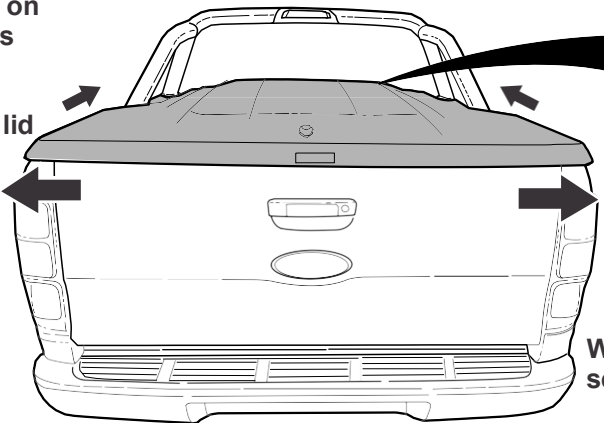

**When lid is aligned correctly, secure the catch hinge to the lid using 4 M8 Thick Washers and M8 Bolts**

**Important:**  
**Ensure tongues are fully inserted into the hinge slots with hinge pin securely in place.**

With the Hard Tonneau Cover opened, attach the cylinder end of each gas strut onto the mounting brackets attached to the Hard Tonneau Cover by clicking into place  
**Refer to Fig. 9**

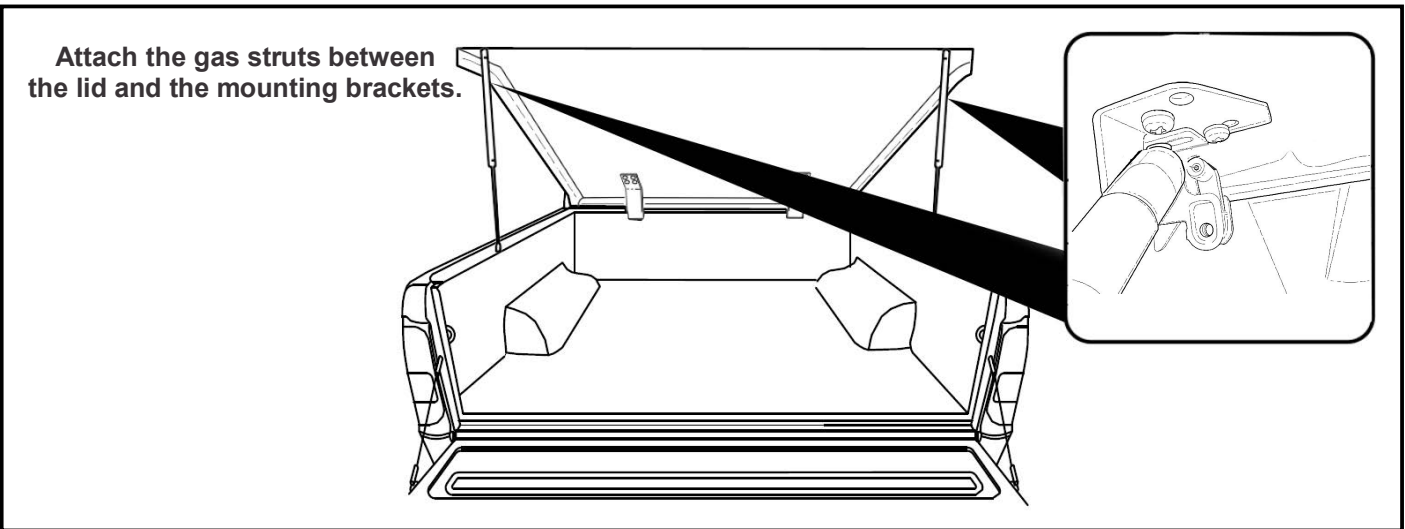

**Fig. 9 - Attach gas strut**

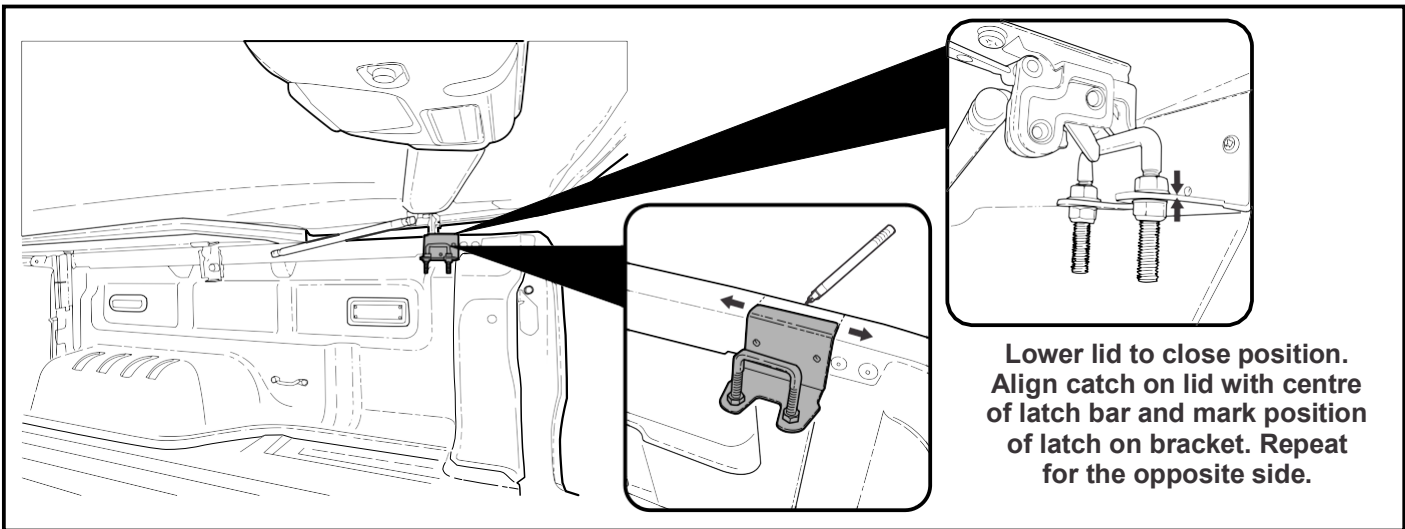

**Important:**  
If you have purchased a Central Locking Ute Lid please ignore the next page concerning Lock Bracket Installation and Lock Bracket adjustment.

Fasten latch bracket  
in place with self-tapping  
screws.

Repeat for the opposite  
side.

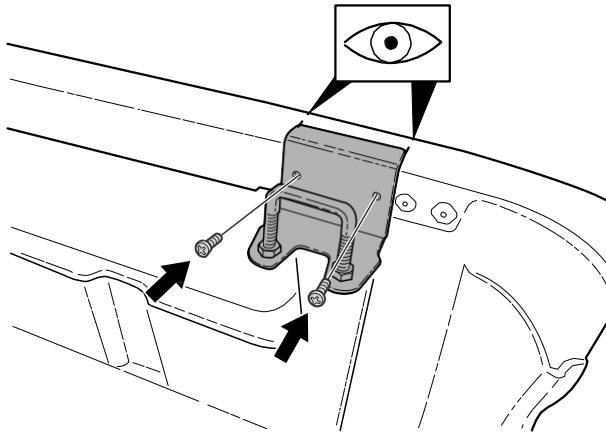

Loosen 2 screws and slide  
catch to align correctly with  
latch bar. Tighten screws to  
secure in place.

Adjust nuts on latch bar to  
alter height of bar to suit.

Repeat for the opposite  
side.

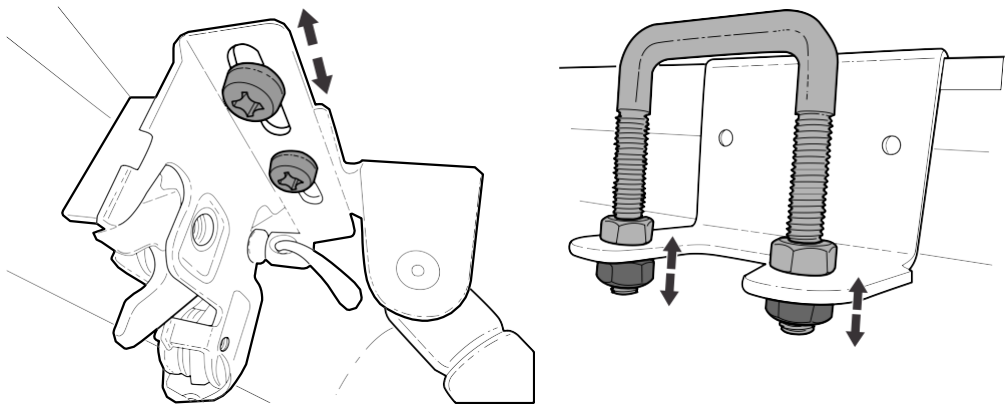

Use an Allen key to loosen the hex key  
screw on the catch and tension cable  
so it is tight but doesn't move the catch  
at all, then re-tighten the hex key screw.

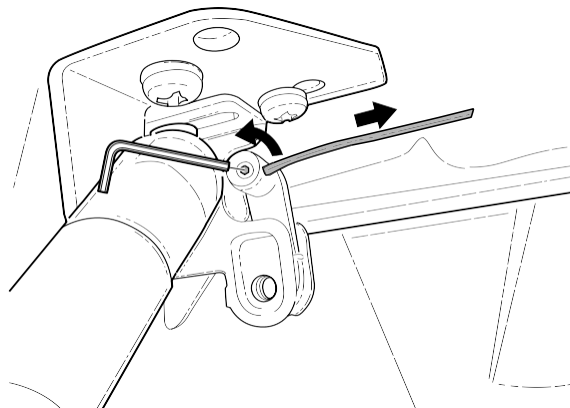

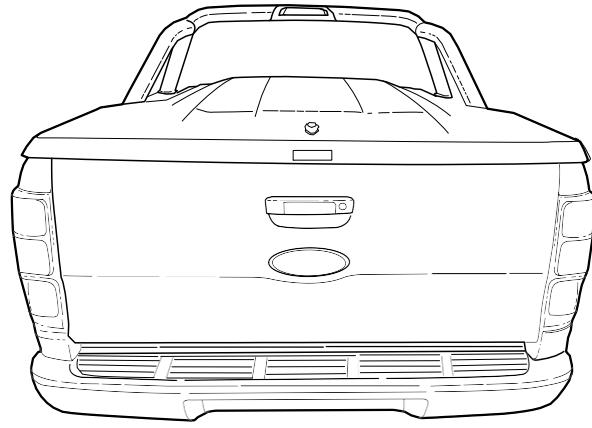

## REMOVAL OF TONNEAU COVER

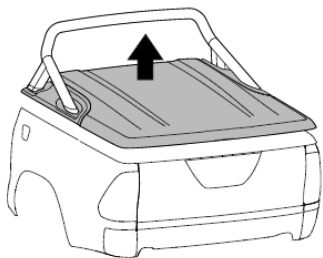

FIGURE 1

1. Open tonneau cover. Disconnect harness at front Header bar. Detach gas strut (1) by inserting a small screwdriver and adjusting the spring clip (2) on the gas strut(1). Refer to figure 2.

**NOTE:** Do not remove the spring clip, only a small amount of levering is required to detach.

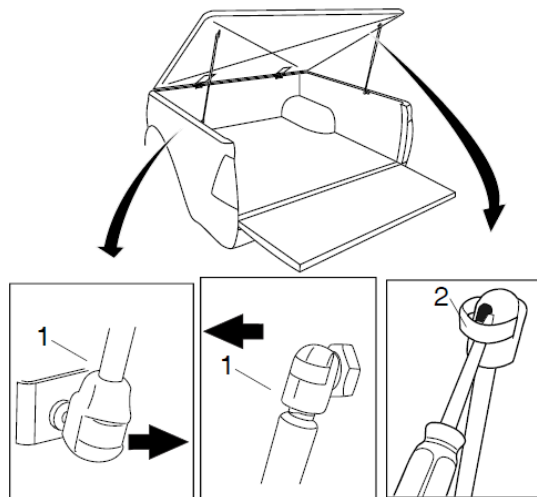

FIGURE 2

**NOTE:** 2 people are required to lift and remove the tonneau cover from the vehicle.

2. Remove hinge pins (1) and remove tonneau cover (2). Refer to figure 3.

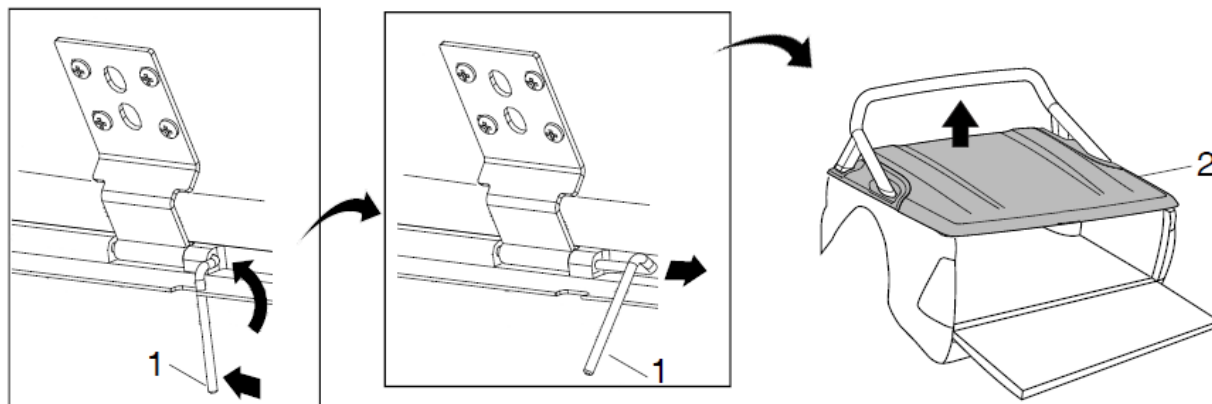

FIGURE 3

## REPLACEMENT OF TONNEAU COVER

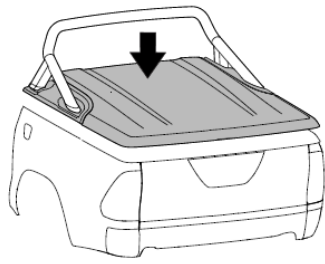

FIGURE 4

NOTE: 2 people are required to lift and fit the tonneau cover onto the vehicle.

1. Fit tonneau cover (2) and secure hinges with hinge pins (1). Refer to figure 5.

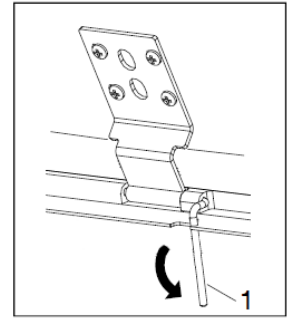
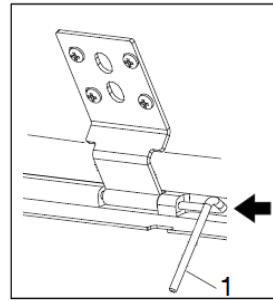
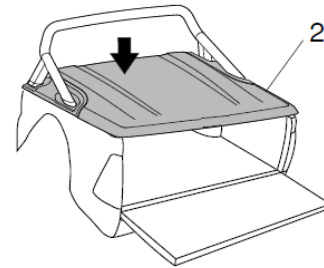

FIGURE 5

2. Attach gas struts (2) by clipping into place. Ensure narrow end (1) mounts to the vehicle. Reconnect harness at front header bar. Refer to figure 6.

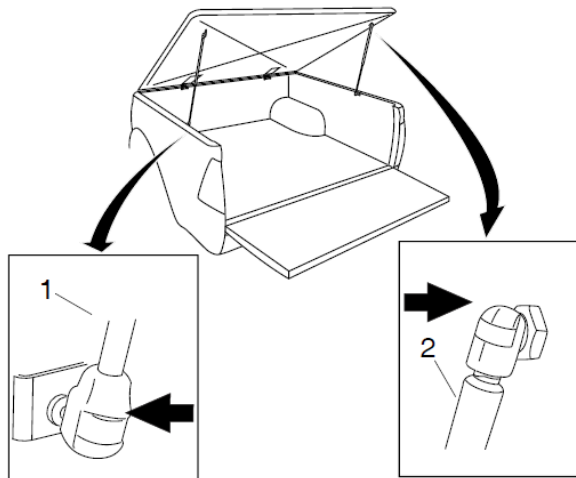

FIGURE 6

### Paint care instructions:

Your new painted Hard Tonneau Cover has been covered with a plastic film to protect the paint from damage. It will require cleaning and possibly light polishing after the protective film has been removed. Use polish as per new paint on a new vehicle. Wash Hard Tonneau Cover using water and normal carwash detergent and polish with an automotive polish.

**NOTE: Please ensure Lid is kept locked at all times when not being used, for both safety and longevity.**

**Having trouble? Call your Supplier.**